

First floor

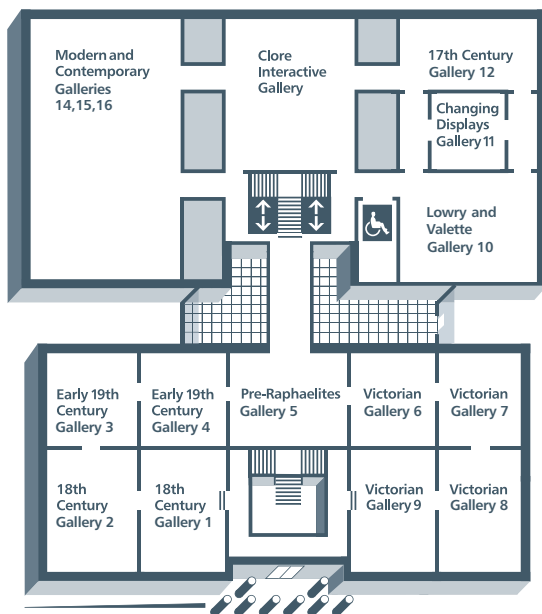

We hope you enjoyed this highlights trail.

To find out more about our collections you can:

Check out our website at www.manchestergalleries.org

Pick up a free audioguide from our information desk in the atrium.

Buy a copy of *Up Close*, a guide to our collections, on sale in the gallery shop for £4.95.

Or just ask a member of our staff. They'll be happy to help.

Ground floor



MANCHESTER
CITY COUNCIL

Manchester Art Gallery

Mosley Street, Manchester M2 3JL

Tel: 0161 235 8888

Fax: 0161 274 7145

Textphone: 0161 235 8893

www.manchestergalleries.org

Discover Manchester Art Gallery Collections Highlights Trail

Three floors. 21 rooms. Over 2,000 items on display spanning over six centuries. No wonder our collection is so renowned.

Short of time? We've put together a brief selection of highlights to help introduce you to our collection which you can easily see in under an hour.



Cheetah and Stag with Two Indians
George Stubbs
Gallery 1. 18th Century Galleries. First floor.
 This painting is a masterpiece by one of the great British artists. George Stubbs is most famous for his paintings of horses. The painting reflects the true story of how an Indian cheetah was given to King George III. Find out what happened when the cheetah was let loose on a British stag at Windsor Park.

Purchased with the assistance of the Victoria & Albert Museum Purchase Grant Fund and The Art Fund.

India House, Manchester
Pierre Adolphe Valette
Gallery 10. Lowry and Valette Gallery. First floor.

Adolphe Valette was a French artist who created a remarkable series of impressionistic paintings of Edwardian Manchester. His pictures, which include this atmospheric depiction of the River Medlock from Oxford Road Bridge, are much loved by our visitors. Valette lived in Manchester from 1905 to 1928, and the gallery has the most important collection of his work in the world.



Work
Ford Madox Brown

Gallery 5. Pre-Raphaelite Gallery. First floor.
 Manchester Art Gallery's Pre-Raphaelite paintings are admired around the world. *Work* is one of the most famous of these. Ford Madox Brown was a friend of the Pre-Raphaelites. *Work* beautifully illustrates the moral value of work to both the individual and to the community, through the depiction of a London street crowded with characters from all walks of life.



Portrait of Henrietta Moraes
Francis Bacon
Gallery 15. Modern and Contemporary Galleries. First floor.

Francis Bacon is one of the most important British artists of the 20th century. This nude portrait of his friend Henrietta Moraes is typical of his expressive and often disturbing distortions of the human figure. Bacon's method of painting is fascinating too; he often used his hands and old clothes, as well as brushes, to recreate the sensation rather than the reality of what he saw.



Escritoire or writing desk
Designed by William Burges
Made by Gualbert Saunders
Gallery 5. Pre-Raphaelite Gallery. First floor.
 Eccentric interior designer and architect William Burges shared the Pre-Raphaelite painters' enthusiasm for the Middle Ages. His colourful desk is inspired by Medieval painted furniture and cathedral architecture. Fantastic decoration is combined with ingenious features like a built-in clock.

Filter 2002
Antony Gormley
Second floor stairwell.

Antony Gormley is famous for his iconic sculptural installations such as *The Angel of the North* in Gateshead and *Another Place* at Crosby Beach in Merseyside. Gormley often uses casts of his own body to investigate the experience of being in a body in the world.

Filter, a recent acquisition for the gallery, is a figure made of welded flat steel rings, inside which is a form located in the place of the heart.

See it suspended from our top floor.

Purchased with the assistance of The Art Fund and the Livingstone and Bloom Charitable Trusts

Image courtesy Jay Jopling/White Cube © The artist

